

RIVERSIDE TOWNHOMES
1300 N RIVERSIDE DR.
POMPANO BEACH, FL 33062

REVISIONS:

REVISIONS:

DATE 06/27/2023

DRAWN : REVIEW

SCALE

DRAWING TITLE:
**FIRST FLOOR
LIFE SAFETY PLAN**
SHEET No:

LS-1

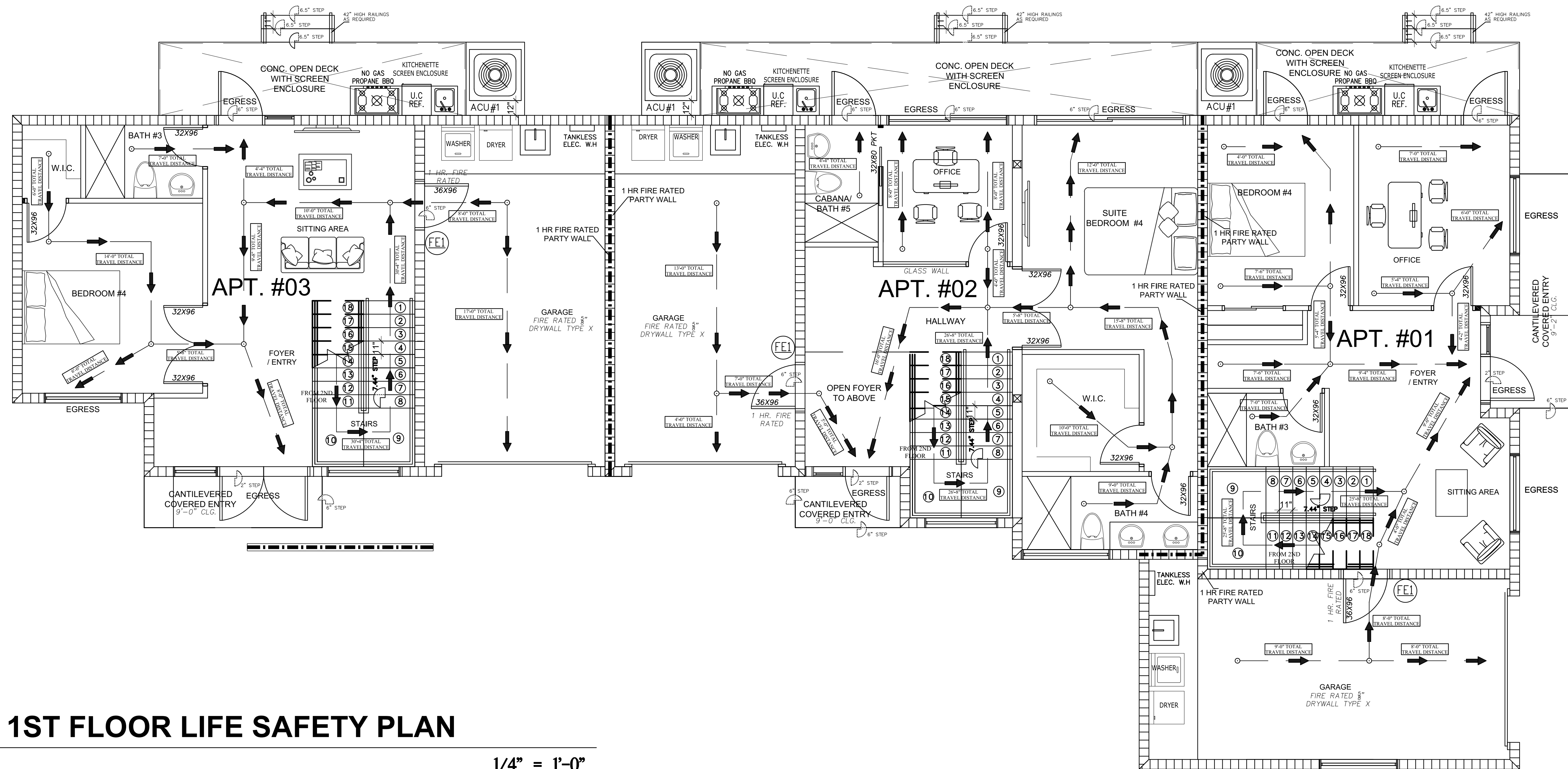

1ST FLOOR LIFE SAFETY PLAN

1/4" = 1'-0"

LIFE SAFETY SYSTEM:

SPRINKLED	YES
EMERGENCY LIGHTING	NO
EXIT SIGNS	NO
FIRE ALARMS AND SMOKE DETECTION SYSTEM	YES
PANIC HARDWARE	NO

DESIGN CODES

LIFE SAFETY	NFPA LIFE SAFETY CODE 2020
ACCESSIBILITY CODE	FLORIDA BUILDING CODE ACCESSIBILITY 2020
FIRE PREVENTION	FIRE PREVENTION CODE - 2020 7TH EDITION OF NFPA 1 & NFPA 101 WITH FLORIDA AMENDMENTS & PALM BEACH COUNTY LOCAL AMENDMENTS

903.2.11.3 BUILDINGS THREE STORIES OR MORE IN HEIGHT ANY BUILDING WHICH IS OF THREE STORIES OR MORE IN HEIGHT SHALL BE EQUIPPED WITH AN APPROVED AUTOMATIC SPRINKLER SYSTEM INSTALLED IN ACCORDANCE WITH SECTION 903.1.

EXCEPTIONS:

- SINGLE- AND TWO-FAMILY DWELLINGS. A STAND-ALONE PARKING GARAGE CONSTRUCTED WITH NONCOMBUSTIBLE MATERIALS, THE DESIGN OF WHICH IS SUCH THAT ALL LEVELS OF THE GARAGE ARE UNIFORMLY OPEN TO THE ATMOSPHERE ON ALL SIDES WITH THE PERCENTAGES OF OPENINGS EQUAL TO OR GREATER THAN THOSE SPECIFIED IN SECTION 406.3. SUCH GARAGES SHALL BE SEPARATED FROM ANY OTHER STRUCTURE BY NOT LESS THAN 20 FEET (6096 MM).
- A STAND-ALONE PARKING GARAGE IS ONE THAT IS SOLELY FOR THE PARKING OF VEHICLES AND DOES NOT HAVE ANY OTHER OCCUPANCY GROUP IN THE BUILDING.
- TELECOMMUNICATION SPACES LOCATED WITHIN TELECOMMUNICATION BUILDINGS, IF THE SPACES ARE EQUIPPED TO MEET AN EQUIVALENT FIRE PREVENTION STANDARD APPROVED BY BOTH THE FLORIDA BUILDING COMMISSION AND THE STATE FIRE MARSHAL.
- TELECOMMUNICATIONS SPACES WITHIN TELECOMMUNICATION BUILDINGS, IF THE TELECOMMUNICATIONS SPACE IS EQUIPPED WITH:

NFPA 101 AS ADOPTED BY FLORIDA FIRE PREVENTION CODE, AS REGARDING THE REQUIREMENTS FOR FIRE PROTECTION SPRINKLERS, IS APPLICABLE TO ALL MULTIPLE-FAMILY RESIDENTIAL BUILDINGS, WHETHER DESIGNATED AS TOWNHOUSES, CONDOMINIUMS, APARTMENT HOUSES, TENEMENTS, GARDEN APARTMENTS OR BY ANY OTHER NAME.

LIFE SAFETY PLAN LEGEND

— —	DIRECTION OF EGRESS TRAVEL
➔	POINT OF EXIT DISCHARGE
○	STARTING POINT OF TRAVEL DISTANCE
— TOTAL TRAVEL DISTANCE	TRAVEL DISTANCE TO REACH AN EXIT 200'-0" MAX TRAVEL DISTANCE

FIRE EXTINGUISHERS

BUSINESS AREAS:

CLASS A
ORDINARY (MODERATE) HAZARD

MAX. 3,000 S.F. OF AREA TO BE
PROTECTED
MAX. 75'-0" OF TRAVEL DISTANCE



FIRE EXTINGUISHER:

MULTIPURPOSE DRY CHEMICAL
TYPE :
MP5, 5 LBS, UL 2A-10B:C ON
STANDARD
WALL HUNG MOUNTING BRACKET



FIRE EXTINGUISHER NOTE

FIRE EXTINGUISHERS SHALL HAVE A MINIMUM RATING OF 2A:10BC AND SHALL BE TAGGED BY A LICENSED FIRE EXTINGUISHER COMPANY. TRAVEL DISTANCE SHALL NOT EXCEED 75'-0" FEET